

Data sheet

| | |
|-------------|---|
| ID | AFT/MBS WS |
| Description | adaptor with female thread and male bush |
| Properties | for the connection of rigid or pliable conduits with distribution and enclosure boxes |
| Colour | white, similar to RAL 9010 |

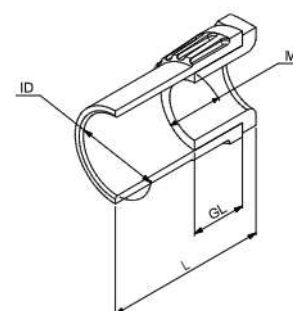

Working temperature
 -5 to 60 °C

| Art. no. | Nominal diameter | Thread connection size | Thread length | Total length | Small Package | Large Package |
|----------|------------------|------------------------|---------------|--------------|---------------|---------------|
| 010 183 | 16 mm | M16 x 1.5 | 11 mm | 30 mm | 100 pc | 2400 pc |
| 010 184 | 20 mm | M20 x 1.5 | 14 mm | 35 mm | 100 pc | 1200 pc |
| 010 185 | 25 mm | M25 x 1.5 | 14 mm | 45 mm | 50 pc | 600 pc |
| 010 186 | 32 mm | M32 x 1.5 | 14 mm | 48 mm | 20 pc | 480 pc |
| 010 187 | 40 mm | M40 x 1.5 | 14 mm | 52 mm | 25 pc | 300 pc |
| 010 188 | 50 mm | M50 x 1.5 | 16 mm | 66 mm | 10 pc | 120 pc |

Areas of Recommended Application

| Area | |
|--|-------|
| Approved in combination with protective conduit CSA | False |
| Approved in combination with protective conduit UR | False |
| Approved in combination with protective conduit VD TÜV/GGVS | False |
| Approved in combination with protective conduit DIN EN 61386-23 | False |
| Approved in combination with protective conduit Lloyd's Register | False |

Further technical details

| Details | |
|--------------------|--------------------|
| Model | Straight |
| Revolving thread | False |
| Construction type | Internal thread |
| Type of connection | Plug-in connection |
| Thread type | Metric |
| Material sealing | No sealing |
| Material | PVC-U |